

ATRA-FLEX®

Flexible Couplings

Proudly manufactured in the USA, ATRA-FLEX has been the quality choice coupling for major pump manufacturers across the globe for over 36 years. Our customer service, comprehensive technical support and quick lead times have set us apart. Once customers experience the ATRA-FLEX® value we have a customer for life.

Exceeding Expectations in the PUMP INDUSTRY



When choosing a coupling for all your industrial pump needs, customers turn to the innovators behind the simplicity of our non-lubricated, replace in place design. Customers choose the high quality ATRA-FLEX is recognized for when longer equipment life, ease of installation and low maintenance is a priority. With the ability to drop in and out of place without having to displace or realign your equipment, ATRA-FLEX® Flexible couplings continue to stand above the rest.



- Flexible design accommodates misalignment and protects equipment
- No lubrication required = Low Maintenance and no EPA regulations, less downtime labor and expense
- Easy Installation and ease of replacing inserts without having to move driver or driven equipment saves you money
- Quality, all machined parts using high grade solid carbon steel rounds provides excellent inherent balancing
- Wide variety of custom polyurethane inserts options that can handle high heat up to 350 degrees F, high torque and high dampening options.

ATRA-FLEX® Millennium®



- No lubrication needed, low maintenance
- Torque ratings up to 3,610,000 (lb-in)
- Detect and lock on ring
- Superior design "Internal Support" of Insert for higher horse power vs. knockoff brands
- Higher horse power in a smaller package saves you on initial cost
- Large bore capacity; up to 16 inch shafts
- No exposed shaft on spacer coupling
- Very economical, no metal to metal contact; no need to replace hubs

ATRA-FLEX® T-FLEX® Patent # 7,244,186

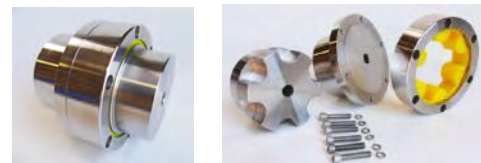

- Stability of a compression style, safety of a shear
- Higher performance; absorbs extreme torsional shock and vibration which equals longer equipment life
- Compact size to torque ratio
- Torque ratings up to 1,570,000 (lb-in)
- Shaft capacities up to 20 inches; low rpm up to 18,000 rpm
- Bolt on ring. Suitable for vertical and stop, start applications

ATRA-FLEX® Can retro-fit right up to an existing Falk Grid Flange within minutes and save you on maintenance costs and messy lubrication



Millennium® Exploded View

Superior Design to A series, More torque in a smaller package. T-slot and lock on ring.

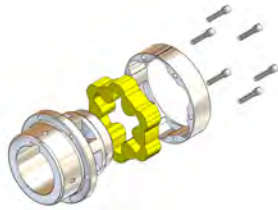

T-Flex® Exploded View

Less Reactionary Loads, bolt on ring



A Series® Exploded View

ATRA-FLEX innovated, others followed.

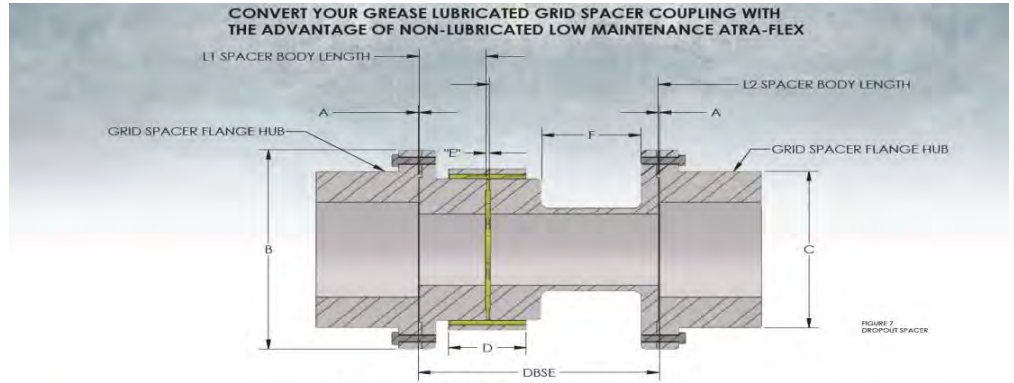

DIMENSIONS GRID DROP-OUT CONVERSION CHART

GRID SIZE	SIZE ATRA-FLEX	ANSI STD DBSE	A	B	C	D (RING WIDTH)	F	"E"	L1	DBSE/ =L2	G (BC)
1020 T31	20SB0MF	3.5	.050	3.300	2.060	1.145	1.700	.075	0.900	3.500 = 2.600	2.835
		4.380					2.580			4.380 = 3.480	
		5.00					3.200			5.000 = 4.100	
1030 T31	30SB1MF	3.5	.050	3.618	2.340	1.57	0.900	.075	1.300	3.500 = 2.200	3.110
		4.380					1.780			4.380 = 3.080	
		5.00					2.400			5.000 = 3.700	
1040 T31	40SB2MF	3.5	.050	4.375	3.090	1.600	0.700	.075	1.400	3.500 = 2.100	3.898
		4.380					1.580			4.380 = 2.980	
		5.00					2.200			5.000 = 3.600	
1050 T31	50SB2MF	7.250	.050	4.875	3.440	1.600	1.580	.075	1.400	4.380 = 2.980	3.898
		5.00					2.200			5.000 = 3.600	
		7.250					4.450			7.250 = 5.850	
1060 T31	60SB3MF	5.00	.050	5.690	4.060		1.05	.075	1.975	5.000 = 3.025	4.900
		7.250					3.300			7.250 = 5.275	
		12.250					5.800			9.750 = 7.775	
1070 T31	70SB4MF	5.00	.050	.000	4.310	3.100	0.900	.200	2.1	5.000 = 2.800	5.275
		7.250					3.150			7.250 = 5.050	
		12.250					5.050			9.750 = 7.550	
1080 T31	80SB5MF	7.250	.050	7.000	4.800	3.500	1.350	.200	3.075	7.250 = 4.175	6.000
		9.750					3.850			9.750 = 6.675	
		12.250					6.350			12.250 = 9.175	
1090 T31	90SB5MF	7.250	.050	8.250	5.620	3.500	1.350	.200	3.075	7.250 = 4.175	6.000
		9.750					3.850			9.750 = 6.675	
		12.250					6.351			12.250 = 9.175	

** Refer to horsepower capacity at various RPM on page 4 and page 18
 *** Consult factory for larger sizes

Looking for Cost Savings and Corrosion Resistance?

We continually strive to meet customers' needs.

Melonite™ Process offers a significant cost savings and alternative option to Stainless Steel. Melonite Process available in the complete ATRA-FLEX® Coupling Line.

- Enhanced corrosion resistance
- Lower coefficient of friction
- Enhanced surface lubricity
- Improved running wear performance
- Increased surface hardness



This process has been proven in the field to prevent corrosion caused from applications in wet or chemical environments as well as wear and fretting due to misalignment and vibration. It penetrates the carbon steel and increases the hardness up to a RC of 57.6 This is not a coating and will not chip or wear off.



ATR Sales Inc. Corporation is the proud Manufacturer of ATRA-FLEX® Flexible Couplings

Corporate Headquarters : 110 E. Garry Ave Santa Ana, CA 92707 phone:
 800-443-6613 Fax: 800-988-9896 please visit us @ www.atra-flex.com